

PLTQ



Nominal size		Max working pressure	Rated flow	Max flow rate	Min burst pressure			Fluid spillage		
					Male	Female	Coupled			
DNP	BG	ISO	mm	Mpa	l/min	l/min	MPa	MPa	MPa	cc
06	1	6.3	6	40	12	24	190	190	190	0,008
13	2	10	8,6	35	23	46	150	170	160	0,010
20	3	12.5	10,7	35	45	90	170	150	170	0,012
22	4A	16	12,8	35	74	150	160	140	150	0,015
25	4	19	14,8	35	100	200	160	140	180	0,020
30	5	25	17,6	35	189	280	140	140	150	0,030

Caratteristiche tecniche

- Norma: ISO 16028 – HTMA (DN13)
- Occlusione: faccia piana
- Aggancio: sfere radiali
- Materiale: acciaio
- Finitura: Nit-Ox™
- Resistenza in nebbia salina: > 400 h
- Filettature: BSP – NPT – SAE
- Guarnizioni standard: NBR
- Temperatura d'esercizio: -25 °C +100 °C
- Guarnizioni opzionali: FKM, EPDM o altro
- Pressioni di esercizio: 350-400 bar
- Connessione in pressione: non consentita

Technical data

- Standard: ISO 16028 – HTMA (DN13)
- Occlusion: flat face
- Locking: radial balls
- Material: steel
- Finishing: Nit-Ox™
- Salt spray test resistance: > 400 h
- Threads: BSP – NPT – SAE
- Standard seals: NBR
- Working temperature: -25 °C +100 °C
- Optional seals: FKM, EPDM or more
- Working pressure: 350-400 bar
- Connection under pressure: not allowed

Technische Merkmale

- Norm: ISO 16028 – HTMA (DN13)
- Verschluss: flachdichtend
- Kupplung: Radialkugeln
- Werkstoff: Stahl
- Ausführung: Nit-Ox™
- Widerstand zum Salzspruehnebeltest: > 400 h
- Gewinde: BSP – NPT – SAE
- Standard-Dichtungen: NBR
- Betriebstemperatur: -25 °C +100 °C
- Dichtungen nach Wahl: FKM, EPDM, usw.
- Betriebsdruck: 350-400 bar
- Kuppeln unter Druck: nicht möglich

Caracteristiques techniques

- Norme: ISO 16028 – HTMA (DN13)
- Obturation: clapet plat
- Accrochage: billes radiales
- Matériel: acier
- Traitement: Nit-Ox™
- Resistance à la rouille: > 400 h
- Taraudage: BSP – NPT – SAE
- Joints standard: NBR
- Température de service: -25 °C +100 °C
- Joints facultatifs: FKM, EPDM, ect.
- Pression de service: 350-400 bar
- Connexion sous pression: pas possible

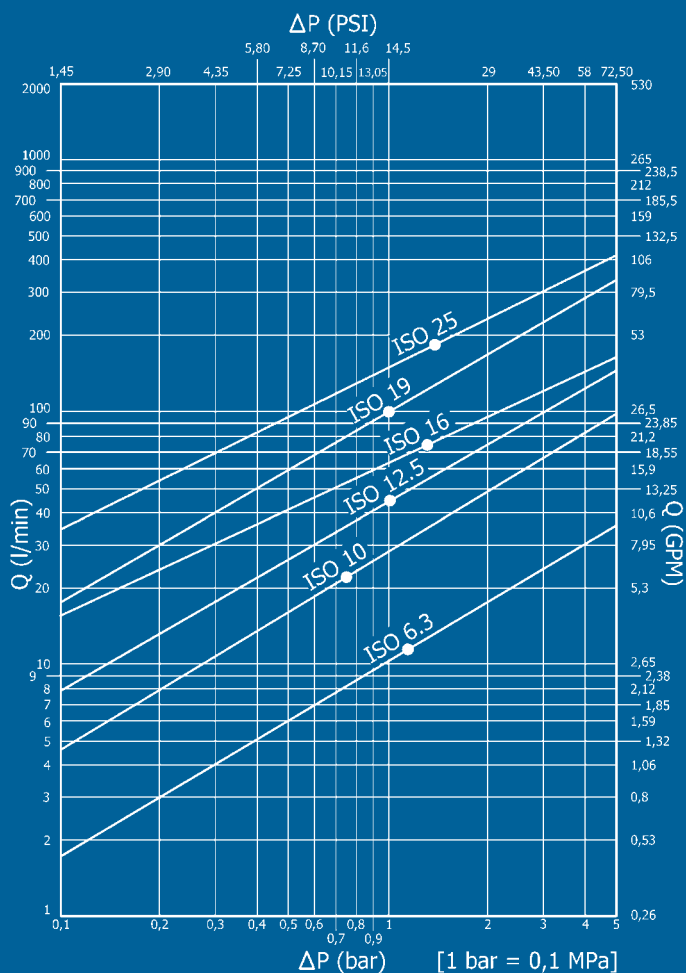

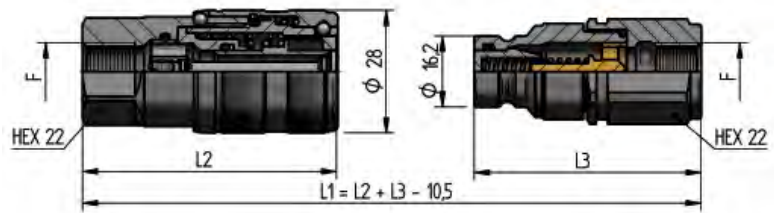
PLTQ DN06 - BG 1 - ISO 6.3

THREADS	L2	L3	F	STANDARD	FEMMINA - FEMALE - MUFFE - FEMELLE			MASCHIO - MALE - STECKER - MALE		
					COD. F	Weight (g)	Packaging (pcs.)	COD. M	Weight (g)	Packaging (pcs.)
IG 1	58,5	52	BSP 1/4"	DIN 3852-2-X	PLTQ.0606.112	181	100	PLTQ.0606.113	98	200
	58,5	52	NPT 1/4"	ANSI B1.20.3	PLTQ.0606.012	182	100	PLTQ.0606.013	99	200
IG 2	58,5	52	9/16"-18 UNF 2B	SAE J 1926-1	PLTQ.0615.032	178	100	PLTQ.0615.033	95	200

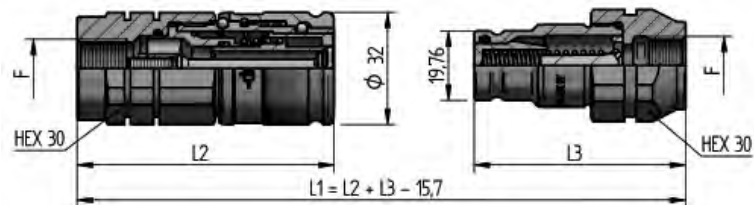
PLTQ DN13 - BG 2 - ISO 10

THREADS	L2	L3	F	STANDARD	FEMMINA - FEMALE - MUFFE - FEMELLE			MASCHIO - MALE - STECKER - MALE		
					COD. F	Weight (g)	Packaging (pcs.)	COD. M	Weight (g)	Packaging (pcs.)
IG 1	73,5	60,5	BSP 3/8"	DIN 3852-2-X	PLTQ.1310.112	309	60	PLTQ.1310.113	158	60
	73,5	63,5	NPT 3/8"	ANSI B1.20.3	PLTQ.1310.012	311	60	PLTQ.1310.013	184	60
	73,5	60,5	BSP 1/2"	DIN 3852-2-X	PLTQ.1313.112	294	60	PLTQ.1313.113	154	60
	73,5	63,5	NPT 1/2"	ANSI B1.20.3	PLTQ.1313.012	297	60	PLTQ.1313.013	168	60
IG 2	72	60,5	9/16-18 UNF 2B	SAE J 1926-1	PLTQ.1315.032	309	60	PLTQ.1315.033	165	60
	73,5	60,5	3/4"-16 UNF 2B	SAE J 1926-1	PLTQ.1319.032	301	60	PLTQ.1319.033	160	60
	74,5	64,5	7/8"-14 UNF 2B	SAE J 1926-1	PLTQ.1323.032	287	60	PLTQ.1323.033	159	60

THREADS

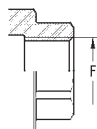
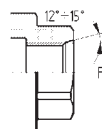

IG 1

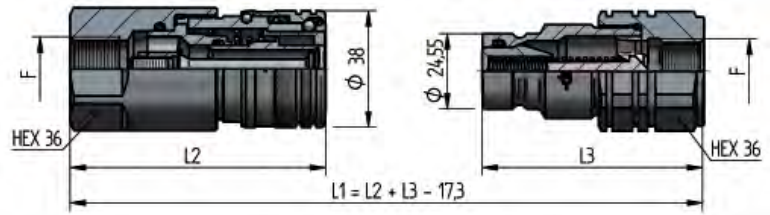
IG 2

PLTQ DN20 - BG 3 - ISO 12.5

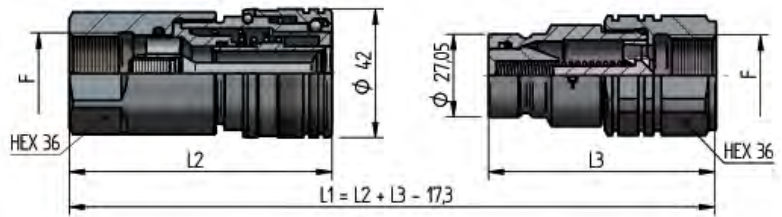

THREADS	L2	L3	F	STANDARD	FEMMINA - FEMALE - MUFFE - FEMELLE			MASCHIO - MALE - STECKER - MALE		
					COD. F	Weight (g)	Packaging (pcs.)	COD. M	Weight (g)	Packaging (pcs.)
IG 1	83,5	72,5	BSP 1/2"	DIN 3852-2-X	PLTQ.2013.112	529	35	PLTQ.2013.113	305	42
	83,5	74	NPT 1/2"	ANSI B1.20.3	PLTQ.2013.012	532	35	PLTQ.2013.013	314	42
	83,5	74,5	BSP 3/4"	DIN 3852-2-X	PLTQ.2019.112	498	35	PLTQ.2019.113	282	42
	83,5	74	NPT 3/4"	ANSI B1.20.3	PLTQ.2019.012	507	35	PLTQ.2019.013	290	42
IG 2	79,5	70	3/4"-16 UNF 2B	SAE J 1926-1	PLTQ.2019.032	507	35	PLTQ.2019.033	293	42
	81,5	74	7/8"-14 UNF 2B	SAE J 1926-1	PLTQ.2023.032	512	35	PLTQ.2023.033	306	42
	83,5	74	1"1/16-16 UN 2B	SAE J 1926-1	PLTQ.2027.032	492	35	PLTQ.2027.033	276	42

PLTQ DN22 - BG 4 - ISO 19



THREADS	L2	L3	F	STANDARD	FEMMINA - FEMALE - MUFFE - FEMELLE			MASCHIO - MALE - STECKER - MALE		
					COD. F	Weight (g)	Packaging (pcs.)	COD. M	Weight (g)	Packaging (pcs.)
IG 1	86	72,5	BSP 1/2"	DIN 3852-2-X	PLTQ.2213.112	576	30	PLTQ.2213.113	330	42
	86	74	NPT 1/2"	ANSI B1.20.3	PLTQ.2213.012	579	30	PLTQ.2213.013	340	42
	86	74,5	BSP 3/4"	DIN 3852-2-X	PLTQ.2219.112	545	30	PLTQ.2219.113	307	42
	86	74	NPT 3/4"	ANSI B1.20.3	PLTQ.2219.012	553	30	PLTQ.2219.013	315	42
IG 2	82	70	3/4"-16 UNF 2B	SAE J 1926-1	PLTQ.2219.032	553	30	PLTQ.2219.033	318	42
	84	74	7/8"-14 UNF 2B	SAE J 1926-1	PLTQ.2223.032	558	30	PLTQ.2223.033	331	42
	86	74	1"1/16-16 UN 2B	SAE J 1926-1	PLTQ.2227.032	538	30	PLTQ.2227.033	301	42

THREADS

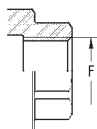

IG 1

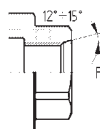

IG 2

PLTQ DN25 - BG 5 - ISO 25

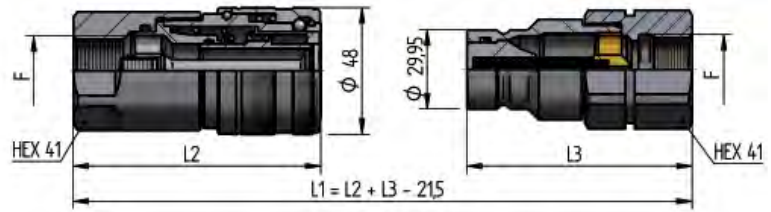

THREADS	L2	L3	F	STANDARD	FEMMINA - FEMALE - MUFFE - FEMELLE			MASCHIO - MALE - STECKER - MALE		
					COD. F	Weight (g)	Packaging (pcs.)	COD. M	Weight (g)	Packaging (pcs.)
IG 1	94,5	86	BSP 3/4"	DIN 3852-2-X	PLTQ.2519.112	808	23	PLTQ.2519.113	491	30
	94,5	86	NPT 3/4"	ANSI B1.20.3	PLTQ.2519.012	814	23	PLTQ.2519.013	498	30
	97,5	86	BSP 1"	DIN 3852-2-X	PLTQ.2525.112	780	23	PLTQ.2525.113	431	30
	97,5	86	NPT 1"	ANSI B1.20.3	PLTQ.2525.012	786	23	PLTQ.2525.013	440	30
IG 2	95	86	1"1/16-16 UN 2B	SAE J 1926-1	PLTQ.2527.032	817	23	PLTQ.2527.033	485	30
	95	86	1"5/16-12 UN 2B	SAE J 1926-1	PLTQ.2533.032	758	23	PLTQ.2533.033	426	30

PLTQ DN30 - BG 7 - ISO 40

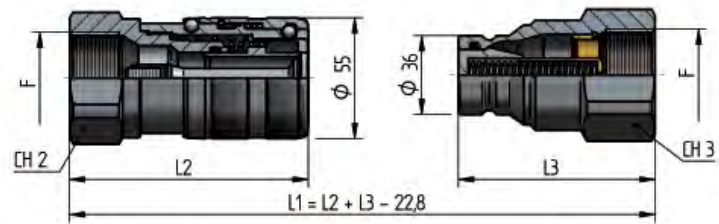

THREADS	CH2	L2	CH3	L3	F	STANDARD	FEMMINA - FEMALE - MUFFE - FEMELLE			MASCHIO - MALE - STECKER - MALE		
							COD. F	Weight (g)	Packaging (pcs.)	COD. M	Weight (g)	Packaging (pcs.)
IG 1	50	109,3	50	90	BSP 1"	DIN 3852-2-X	PLTQ.3025.112	1236	7	PLTQ.3025.113	729	20
	50	109,3	50	90	NPT 1"	ANSI B1.20.3	PLTQ.3025.012	1251	7	PLTQ.3025.013	741	20
	55	109,3	55	90	BSP 1"1/4	DIN 3852-2-X	PLTQ.3031.112	1237	7	PLTQ.3031.113	769	20
	55	109,3	55	90	NPT 1"1/4	ANSI B1.20.3	PLTQ.3031.012	1262	7	PLTQ.3031.013	781	20
IG 2	55	109,3	55	90	1"5/8-12 UN 2B	SAE J 1926-1	PLTQ.3041.032	1235	7	PLTQ.3041.033	768	20

THREADS

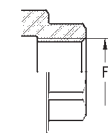

IG 1

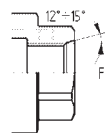

IG 2

PLASTIC



NOMINAL SIZE			FEMALE DUST PLUG			MALE DUST CAP			COLOUR	MATERIAL
DNP	BG	ISO	COD. F	Weight (g)	Packaging (pcs.)	COD. M	Weight (g)	Packaging (pcs.)		
06	1	6.3	SPLT.06002	16	50	SPLT.06003	13	100	RED	PVC
13	2	10	SPLT.13002	21	50	SPLT.13003	15	100	RED	PVC
20	3	12.5	SPLT.20002	29	25	SPLT.20003	26	50	RED	PVC
25	4	19	SPLT.25002	51	20	SPLT.25003	41	40	RED	PVC
30	5	25	SPLT.30002	87	12	SPLT.30003	64	30	RED	PVC

METAL



NOMINAL SIZE			FEMALE DUST PLUG			MALE DUST CAP			COLOUR	MATERIAL
DNP	BG	ISO	COD. F	Weight (g)	Packaging (pcs.)	COD. M	Weight (g)	Packaging (pcs.)		
06	1	6.3	SPLT.06202*	40	100	SPLT.06203*	35	150	-	Aluminium
13	2	10	SPLT.13202*	51	50	SPLT.13203*	40	100	-	Aluminium
20	3	12.5	SPLT.20202*	100	30	SPLT.20203*	65	50	-	Aluminium
22	4A	16	SPLT.22202*	110	25	SPLT.22203*	70	40	-	Aluminium
25	4	19	SPLT.25202*	120	20	SPLT.25203*	80	30	-	Aluminium
30	5	25	SPLT.30202*	155	10	SPLT.30203*	100	20	-	Aluminium

* REALIZZATI SU RICHIESTA DEL CLIENTE - AVAILABLE ON REQUEST - AUF ANFRAGE LIEFERBAR - DISPONIBLES SUR DEMANDE

AUTOMATIC

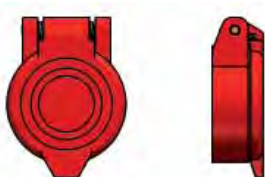

NOMINAL SIZE			AUTOMATIC FEMALE CAP			COLOUR	MATERIAL
DNP	BG	ISO	COD. F	Weight (g)	Packaging (pcs.)		
13	2	10	SPLT.13302	17	100	RED	Nylon
13	2	10	SPLT.13342	17	100	BLACK	Nylon
20	3	12.5	SPPV.13302	22	100	BLACK	Nylon
20	3	12.5	SPPV.13312	22	100	YELLOW	Nylon
20	3	12.5	SPPV.13322	22	100	GREEN	Nylon
20	3	12.5	SPPV.13332	22	100	BLUE	Nylon
20	3	12.5	SPPV.13342	22	100	RED	Nylon

GUARNIZIONI DI RICAMBIO / SPARE PARTS / ERSATZDICHTUNGEN / JOINTS

AL CODICE DELLA GUARNIZIONE IN NBR
AGGIUNGERE 'E' PER EPDM o 'V' PER VITON

TO THE NBR GASKET CODE ADD 'E' FOR EPDM
OR 'V' FOR VITON

ZU DER ARTIKELNR. DER NBR DICHTUNG GEBEN
SIE 'E' FUER EPDM ODER 'V' FUER VITON AN

AU CODE DU JOINT EN NBR JOINDRE 'E' POUR
EPDM OU 'V' POUR VITON

NOMINAL SIZE			FEMALE GASKET		MALE GASKET	
DNP	BG	ISO	NBR	PTFE	NBR	PTFE
06	1	6.3	PLT.006.121	PLT.006.131 N	PLT.006.120	PLT.006.130
13	2	10	PLT.013.121	PLT.013.131 N	PLT.013.120	PLT.013.130
20	3	12.5	PLT.019.121	PLT.019.131 N	PLT.019.120	PLT.019.130
22	4A	16	PLT.022.121	PLT.022.131	PLT.022.120	PLT.022.130
25	4	19	PLT.025.121	PLT.025.131 N	PLT.025.120	PLT.025.130
30	5	25	PLT.031.121	PLT.031.131 N	PLT.031.120	PLT.031.130